



# BrightLock™ Single Emitters

## Features

- Accurate 808nm ± 1nm and narrow linewidth
- Stable wavelength versus temperature 0.08nm/°C
- Wavelength locked from 10°C to 70°C
- Typical efficiency 45%



## Applications

- Industrial DPSS
- Picoprojector laser display

## Benefits

- Constant laser power versus temperature
- Athermal pumping
- Increased pumping efficiency

Model Number	4508-0002	4508-0000
Center Wavelength	808 nm	808 nm
Wavelength Tolerance	± 1 nm	± 1 nm
Spectral width	< 0.5 nm	< 0.5 nm
Output power	700 mW	2.5 W
Operating current	< 0.8A	< 3.5 A
Operating voltage	< 2.2V	< 2.2 V
Threshold current	< 0.25 A	< 0.9 A
Slope Efficiency (@ lth)	> 0.95W/A	> 0.95W/A
Typical Conversion Efficiency	0.45	0.45
Temperature tuning coefficient	0.08nm/°C	0.08nm/°C
Slow axis divergence (FWHM)	< 10 degrees	< 10 degrees
Fast axis divergence (FWHM)	< 25 degrees	< 25 degrees
Emitter width	20 µm	100 µm
Polarization	TE	TE
Mount Type	C-mount	C-mount
Chip bonding	p-down	p-down

Operating conditions at 20 degrees Celsius unless otherwise noted

**Warning:** Class 4 Laser. Invisible Laser Radiation – Avoid Eye or Skin Exposure to Direct or Scattered Radiation.

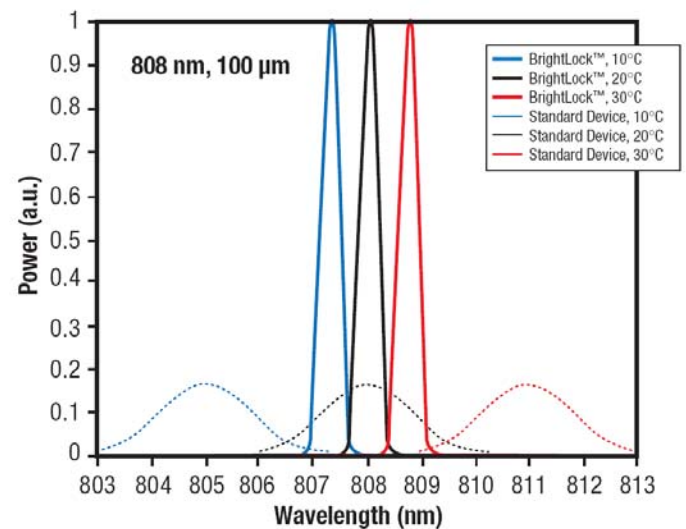
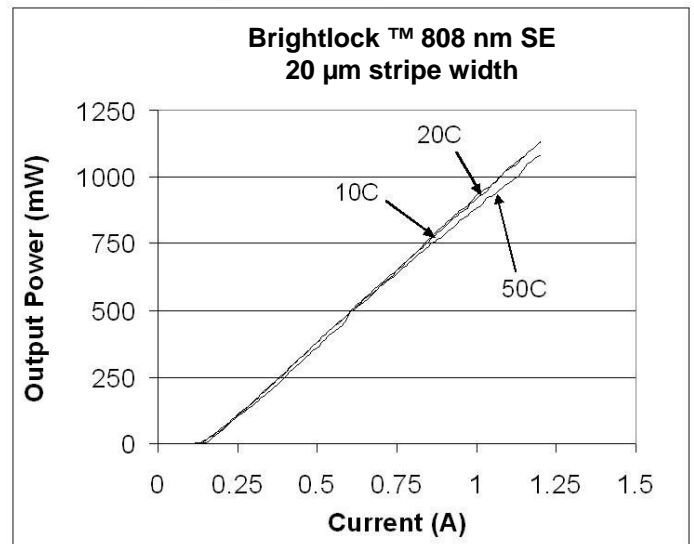

**BRIGHTNESS and POWER**  
*Breaking Performance Barriers through Semiconductor Laser Innovation*





# BrightLock™ Single Emitters

## C-Mount

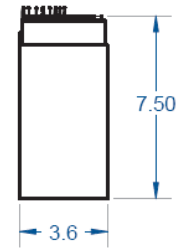
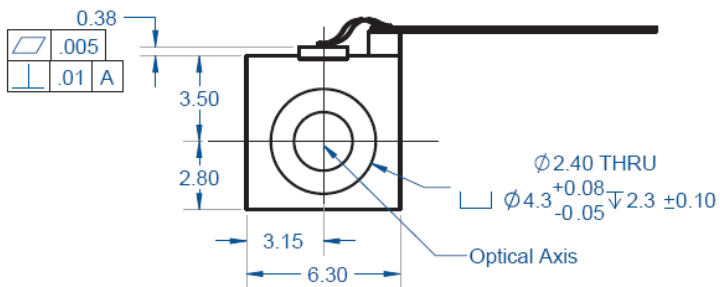
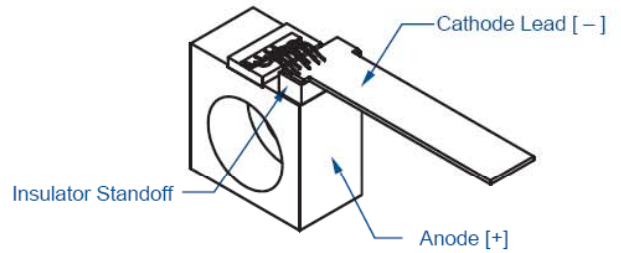
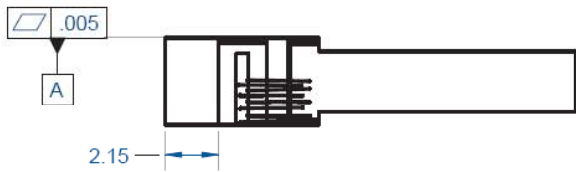

**BRIGHTNESS and POWER**  
**Breaking Performance Barriers through Semiconductor Laser Innovation**

QPC Lasers, Inc.

15632 Roxford Street • Sylmar, CA 91342 • Phone: +1 (818) 986-0000 • Fax: +1 (818) 698-0428  
www.QPCLasers.com • email: info@QPCLasers.com